

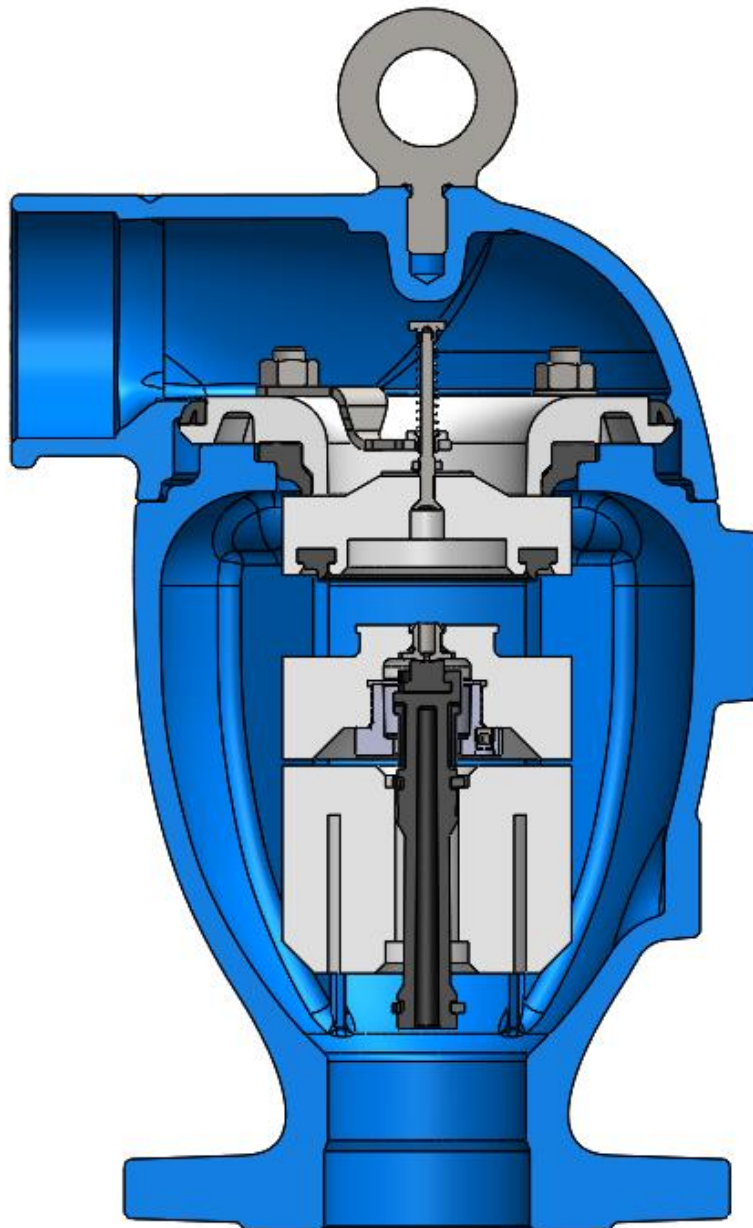

BERMAD

Water Control Solutions

C70
Assisted Closing (AC) Mechanism
2"-4"
Assembly Instructions





BERMAD

Water Control Solutions

Notes:

- This file refers to assemble the AC mechanism on an existed Air valve.
- This file is generic for sizes 2"-4", the exact Serial numbers of the parts are shown in the Kit Assembly drawings.



BERMAD

Water Control Solutions

STEP 1: Assembly of the Surge plate:

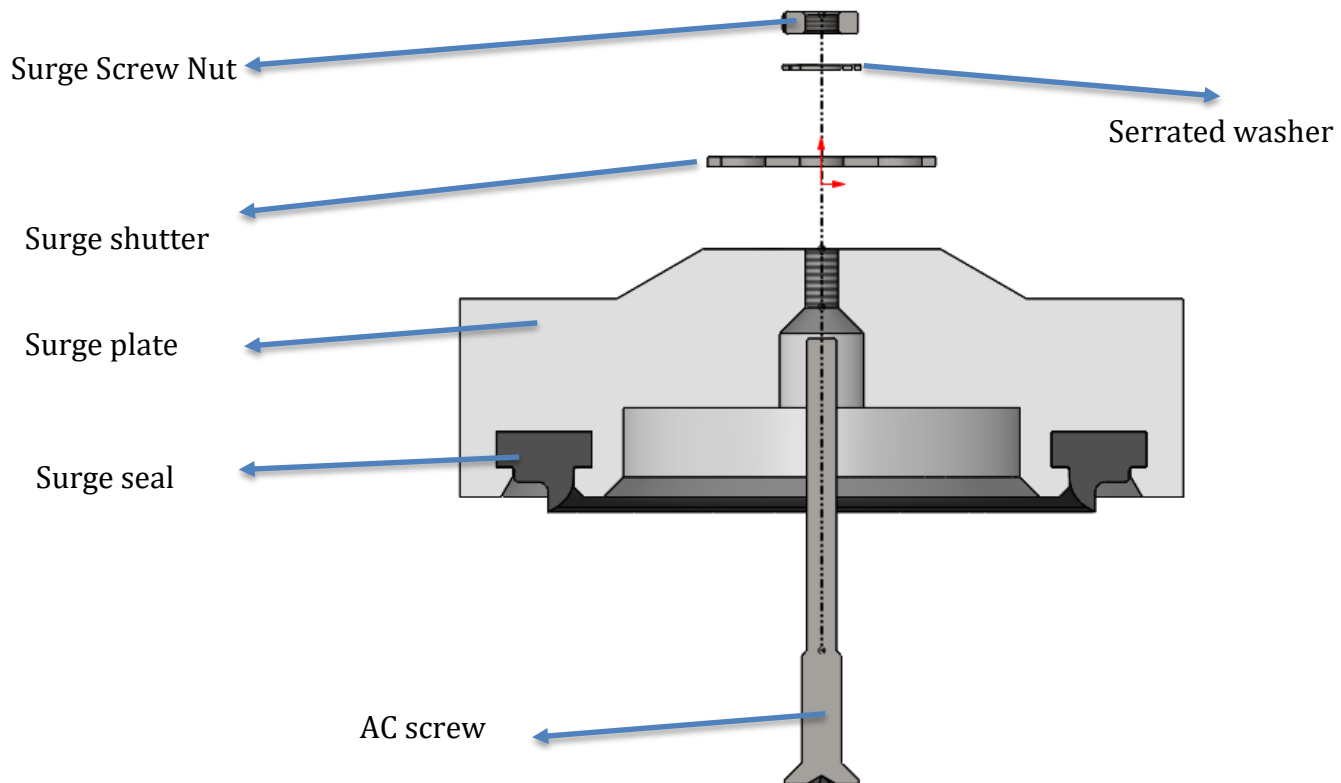



BERMAD

Water Control Solutions

- Make sure that the Shutter plate's holes are in the desired orientation:

Top view:

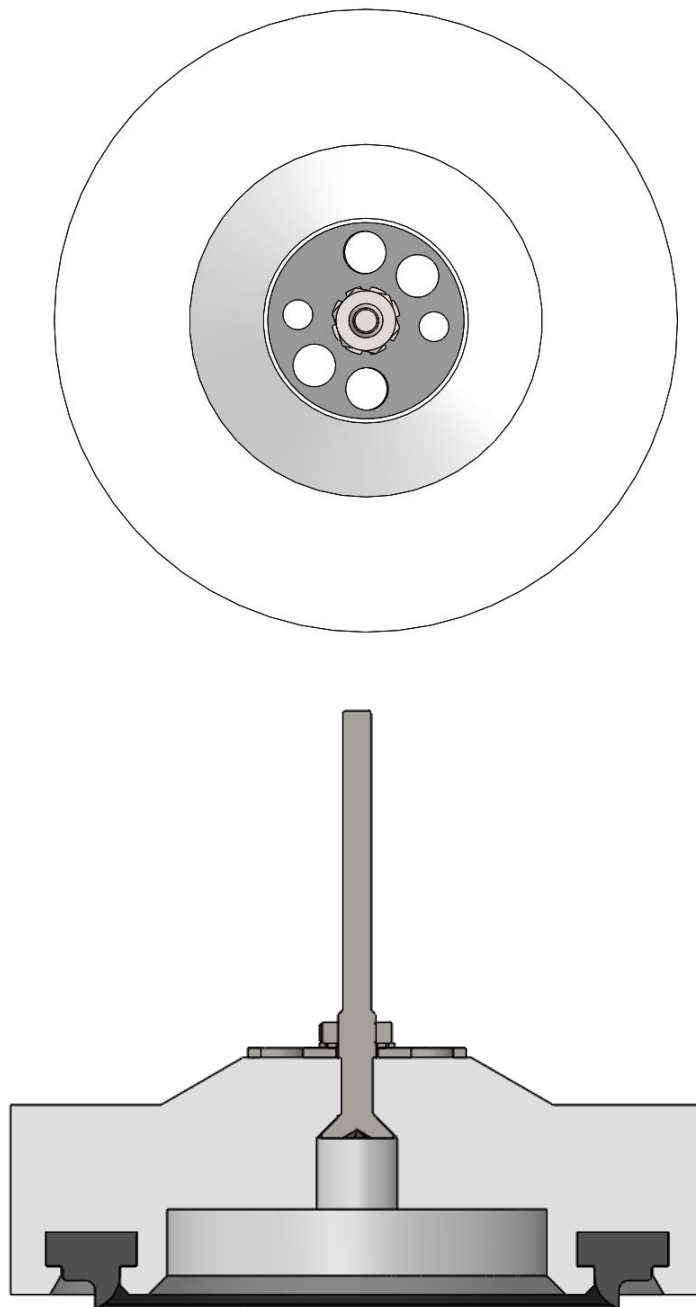



BERMAD

Water Control Solutions

STEP 2: Connecting the AC Bridge on the Top Plate:



- Disassemble the existing Top plate's nuts and washers, and remove the Top Plate and the Top plate's seal from the Valve's body:

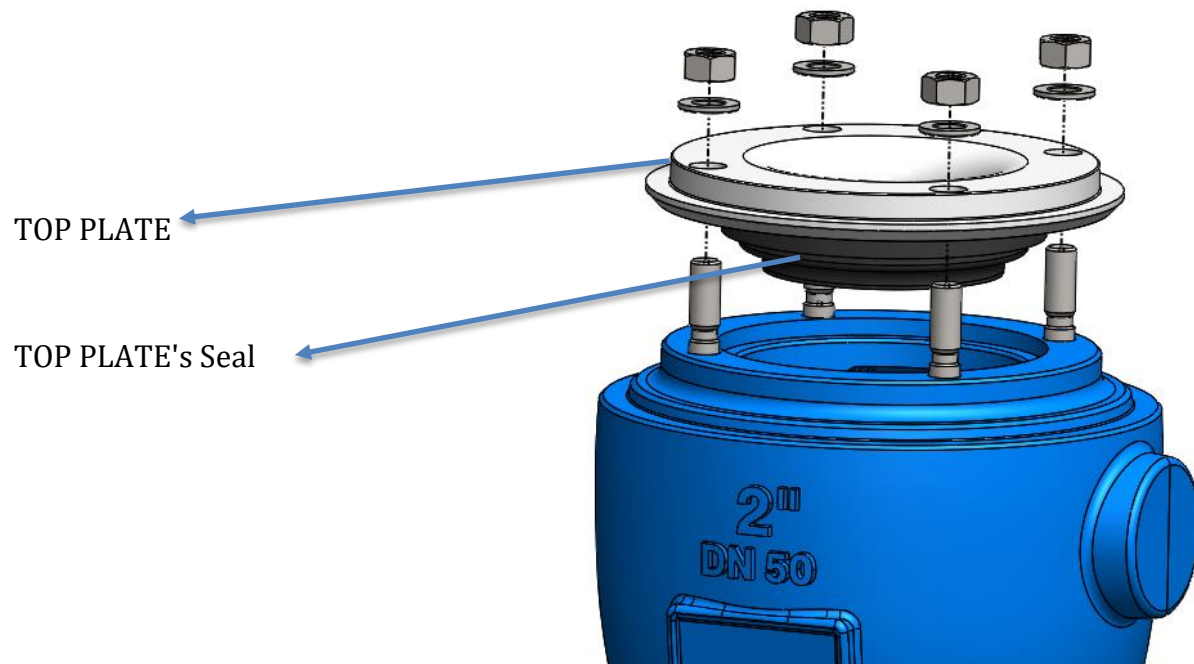



BERMAD

Water Control Solutions

STEP 3: Assembly of the AC mechanism on the Top Plate- Separated from the A.V body:

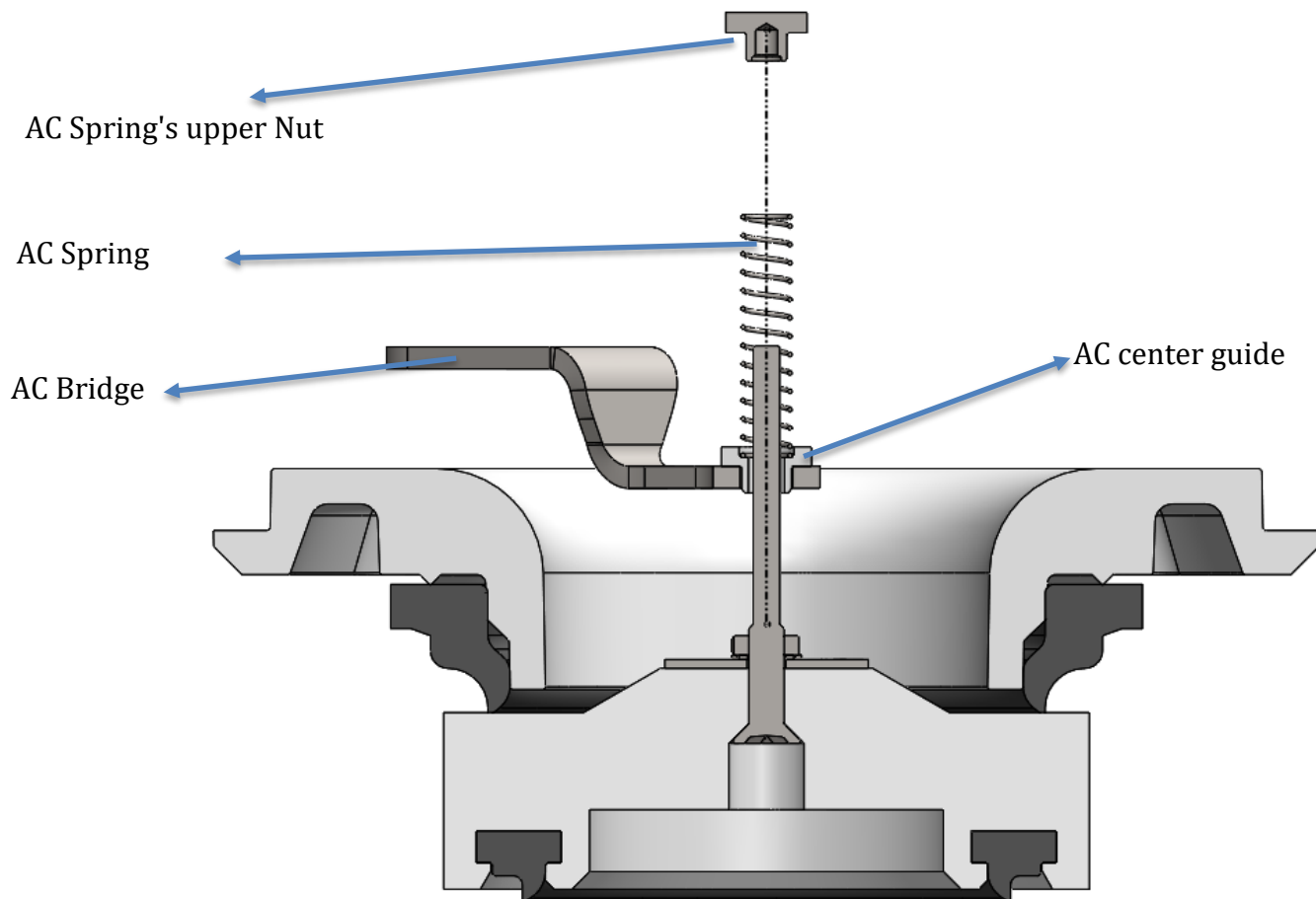



BERMAD

Water Control Solutions

Apply Omnifit 200 Glue on the thread
before tightening

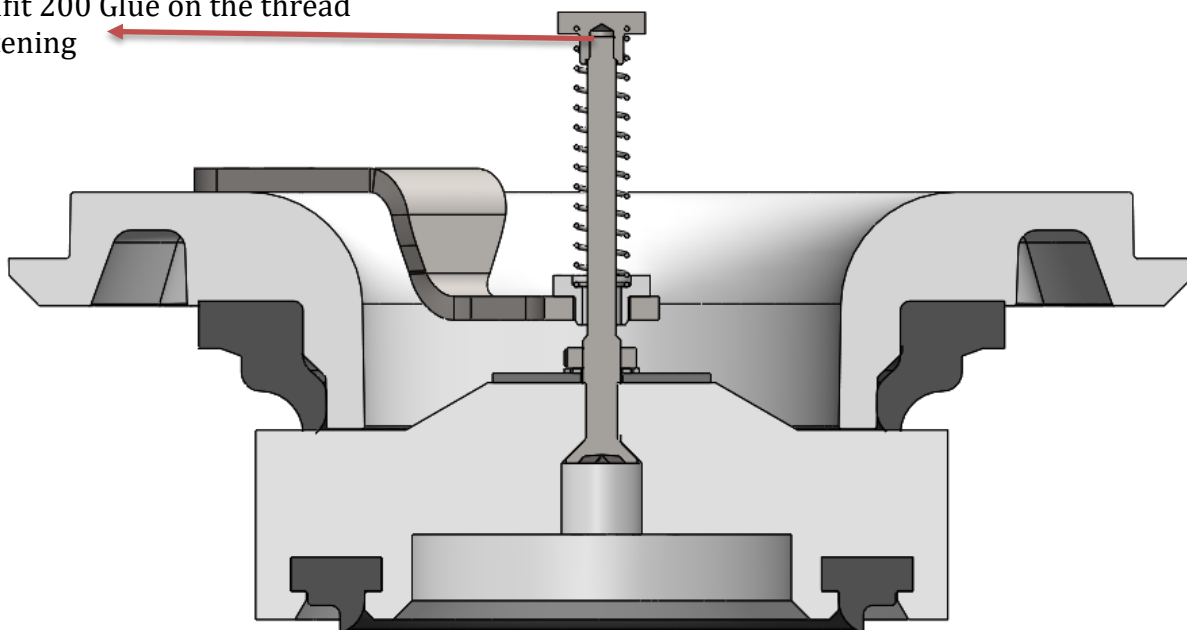

Take the above assembly and insert it to the A.V's body:



BERMAD R&D and Engineering

Office: 04-9857275 • Fax: 073-26557692 • www.bermad.com

Written by : Ohad G.
20.02.2020



BERMAD
Water Control Solutions

STEP 4: Re-Tightening the Top Plate Nuts

Assemble the Top plate nuts (X4) and Washers (x2):

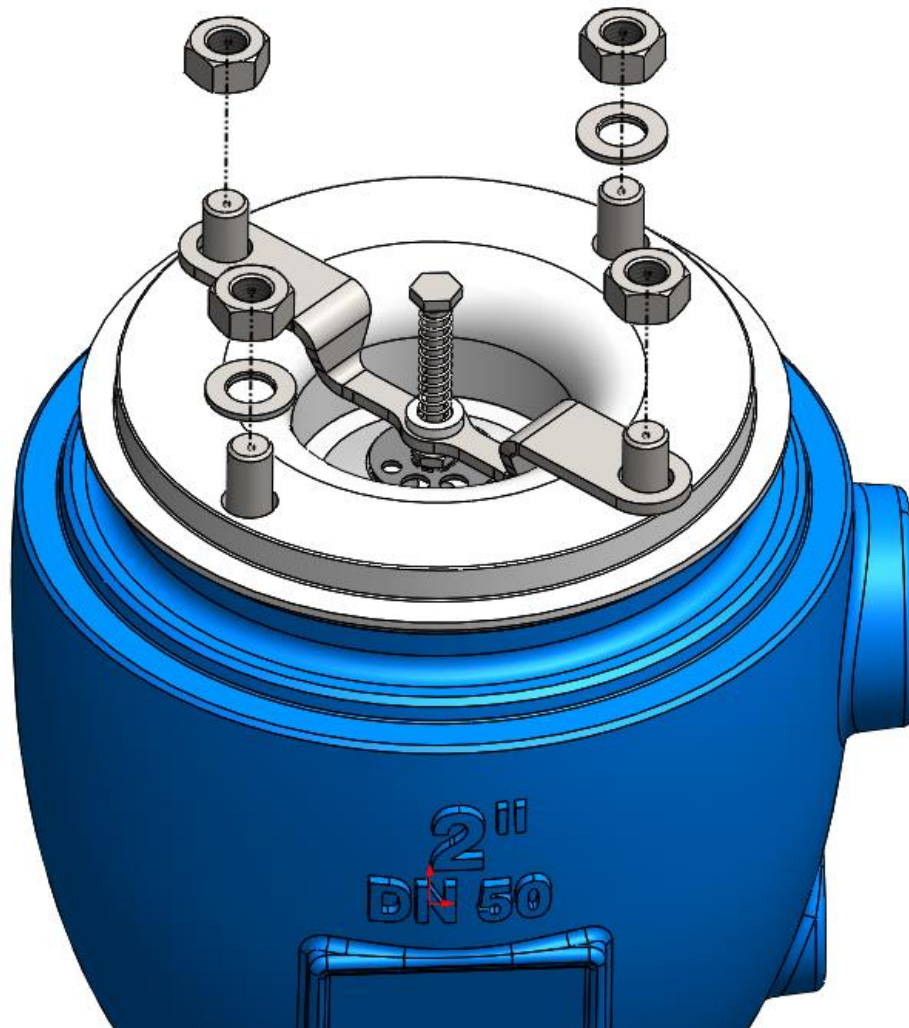

- The recommended Tightening torque should be: 26-30 N*m